



a TxDOT Project
For immediate release

NEWS RELEASE

EL PASO DISTRICT

Jennifer Wright
(915) 790-4340
Jennifer.Wright3@txdot.gov

August 17, 2018

Traffic lane patterns will change on I-10 East near Mesa

I-10 East at Redd is scheduled to close for 27 hours on Sunday, August 26. By Monday, August 27, motorists on I-10 East can expect to be driving on the *median* lanes of I-10.

North Mesa Street

Overnight

Sunday, August 19 and Monday, August 20

8 p.m. to 6 a.m. nightly

- The North Mesa exit ramp (Exit 11) from I-10 Westbound will close.
- North Mesa Street (SH 20) – in the direction traveling toward Doniphan Drive – will close. [No Map]

Continuous

Monday, August 20 at 9 a.m. through Friday, August 24 at 3 p.m.

- The right lane on North Mesa Street (SH 20) – in the direction traveling toward Doniphan Drive – will close between Remcon Circle and Osborne Drive.

Work continues on a storm drain pipe.

Bus Service: The Sun Metro bus stop on North Mesa Street (SH 20) at Osborne Drive will be closed during this work activity. An alternate bus stop is available on North Mesa Street (SH 20) at Crossroads Drive. [No Map]

I-10 West at Sunland

Overnight

Monday, August 20 through Thursday, August 23

9 p.m. to 6 a.m. nightly

- I-10 Westbound will close at Executive Center Boulevard (Exit 16).
- Sunland Park Drive will close in both directions at the I-10 overpass.
- The Sunland Park entrance ramp to I-10 Westbound will close.

Detour: Motorists on I-10 Westbound will exit at Executive Center (Exit 13), then follow it to North Mesa Street (SH 20). Follow the detour signs along North Mesa Street (SH 20) to re-enter I-10 Westbound.

Crews will be constructing the Sunland Park overpass and re-striping lanes on I-10 Westbound.

IMPORTANT: By the morning of Friday, August 24 motorists on I-10 Westbound should slow down as they approach the North Mesa area because lane patterns will be shifted. [No Map]

page 1 of 2



The Texas Department of Transportation is responsible for maintaining 80,000 miles of road and for supporting aviation, rail, and public transportation across the state. GO 10 is a \$158 million reconstruction of Interstate 10 that spans approximately 6 miles on El Paso's West Side between Executive Center Boulevard and North Mesa Street. GO 10 features the addition of collector-distributor lanes and a new direct connector with Border West Expressway.

Maintain a Safe System • Address Congestion • Best-in-Class State Agency • Connect Texas Communities

An Equal Opportunity Employer

www.go10elpaso.com | facebook.com/go10elpaso | twitter.com/go10ep



a TxDOT Project
For immediate release

NEWS RELEASE

EL PASO DISTRICT

Jennifer Wright
(915) 790-4340
Jennifer.Wright3@txdot.gov

I-10 East at Sunland

Overnight

Tuesday, August 21 through Thursday, August 23

9 p.m. to 6 a.m. nightly

- I-10 Eastbound will close at Sunland Park Drive (Exit 13).
- The Sunland Park entrance ramp to I-10 Eastbound will close.

Detour: Motorists on I-10 Eastbound will exit at Sunland Park (Exit 13). Follow the detour signs. [No Map]

I-10 East at Redd

27-HOURS

Sunday, August 26 at 3 a.m. until Monday, August 27 at 6 a.m.

- I-10 Eastbound will close at Redd Road (Exit 9).
- The Redd Road entrance ramp to I-10 Eastbound will close.

Detour: Motorists on I-10 Eastbound will exit at Redd Road (Exit 9), follow it to South Desert Boulevard, then follow South Desert Boulevard to North Mesa Street (SH 20). Motorists may re-enter I-10 Eastbound using the North Mesa Street entrance ramp.

Crews will be moving barrier walls and re-striping lanes on I-10 Eastbound.

IMPORTANT: By the morning of August 27, motorists on I-10 Eastbound at North Mesa Street (SH 20) will experience a change in lane patterns. Please proceed cautiously. [Traffic Alert Map]

All closures are subject to change.

All closure times are approximate.

Exit and entrance ramps may close up to one hour prior to the start time of an I-10 closure.

page 2 of 2



The Texas Department of Transportation is responsible for maintaining 80,000 miles of road and for supporting aviation, rail, and public transportation across the state. GO 10 is a \$158 million reconstruction of Interstate 10 that spans approximately 6 miles on El Paso's West Side between Executive Center Boulevard and North Mesa Street. GO 10 features the addition of collector-distributor lanes and a new direct connector with Border West Expressway.

Maintain a Safe System • Address Congestion • Best-in-Class State Agency • Connect Texas Communities

An Equal Opportunity Employer

www.go10elpaso.com | facebook.com/go10elpaso | twitter.com/go10ep

TRAFFIC ALERT



I-10 EAST CLOSURES FOR 27 HOURS, AUG 26-27

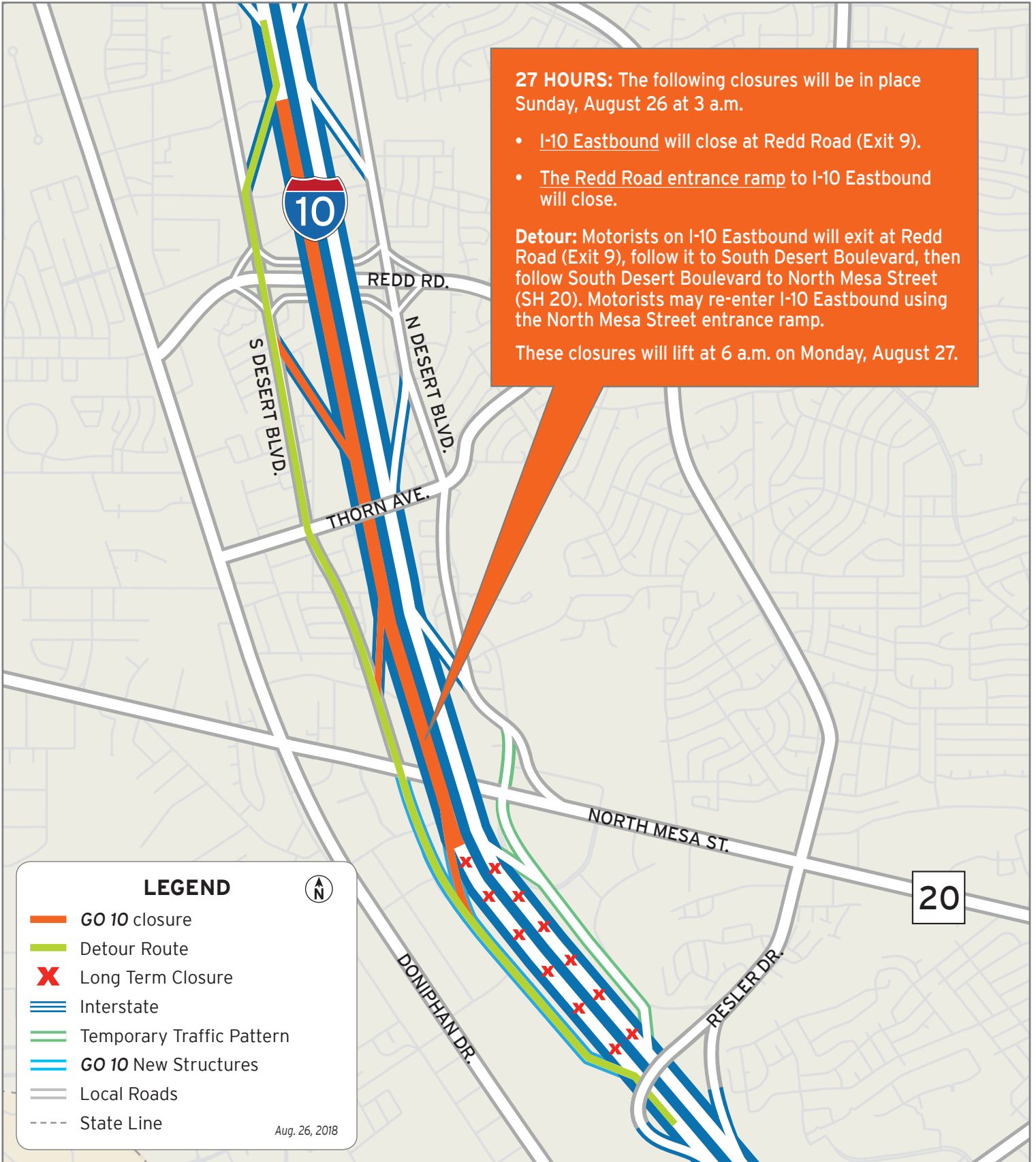

27-HOUR CLOSURE WILL RESULT IN A CHANGE TO TRAFFIC LANE PATTERNS ON I-10 EAST

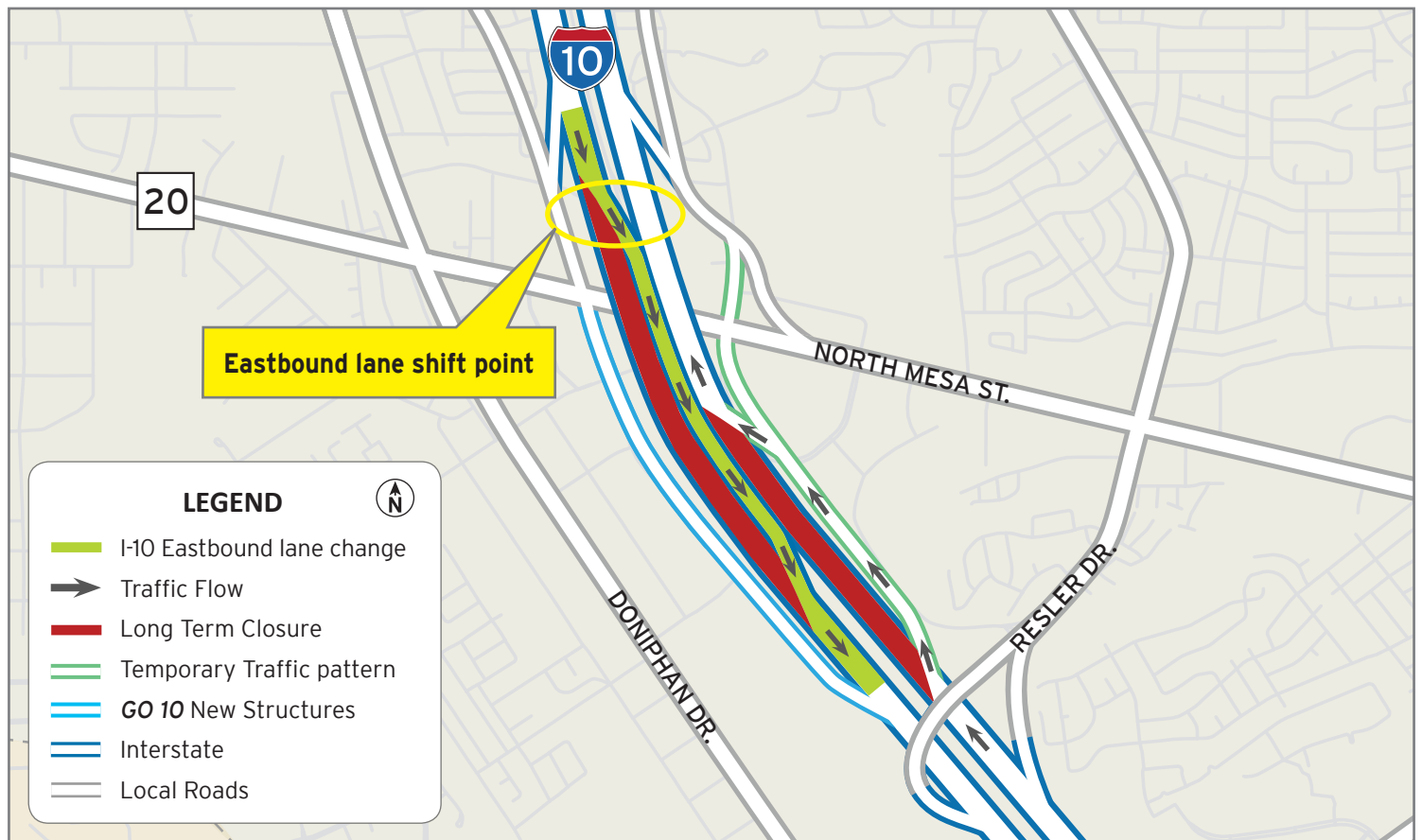

This graphic illustrates the change to lane patterns that motorists can expect on I-10 Eastbound by the morning of Monday, August 27.

As illustrated, the reconfigured lanes will place eastbound motorists onto the median section of I-10 starting at the North Mesa Street overpass. Users of I-10 Eastbound should approach the North Mesa Street area with caution as motorists become adjusted to the new lane geometry starting at 6 a.m. on August 27.

The lane change will stay in place for several months while **GO 10** crews continue to replace pavement on I-10 and make improvements to North Mesa Street (SH 20).

The 27-hour closure of I-10 Eastbound at Redd Road (Exit 9) starts at 3 a.m. on August 26th. All closure details are provided on the other side of this flyer. During the 27-hour closure, motorists may like to avoid I-10 Eastbound at Redd Road and consider an alternate route.

All closures are subject to cancellation. Updates are posted at go10elpaso.com.

