



a TxDOT Project
For immediate release

NEWS RELEASE

EL PASO DISTRICT

Blanca Del Valle
(915) 790-4341
Blanca.DelValle@txdot.gov

April 15, 2016

Mesa

The far right lane on North Mesa Street, in the direction headed toward Doniphan Drive, will be closed between North Desert Boulevard and South Desert Boulevard. The closure will be in place for five days from Monday, April 18 to Friday, April 22. Crews will be placing permanent pavement.

Resler

The westbound Resler Drive Exit Ramp will be closed for four nights:

- > Monday, April 18 from 9 p.m. to 5 a.m. the following morning
- > Tuesday, April 19 from 9 p.m. to 5 a.m. the following morning
- > Wednesday, April 20 from 9 p.m. to 5 a.m. the following morning
- > Thursday, April 21 from 9 p.m. to 5 a.m. the following morning

This is necessary while crews pull fiber cables.

Paisano

The westbound Paisano (US 85) Entrance Ramp to I-10 westbound will be closed for two nights.

- > Wednesday, April 20 from 9 p.m. to 5 a.m. the following morning
- > Thursday, April 21 from 9 p.m. to 5 a.m. the following morning

Crews will be hauling dirt to make way for new direct connector ramps.

All work is dependent upon weather conditions.

###



The Texas Department of Transportation is responsible for maintaining 80,000 miles of road and for supporting aviation, rail, and public transportation across the state. GO 10 is a \$158 million reconstruction of Interstate 10 that spans approximately 6 miles on El Paso's West Side between Executive Center Boulevard and North Mesa Street. GO 10 features the addition of collector-distributor lanes and a new direct connector with Border West Expressway.

Maintain a Safe System • Address Congestion • Best-in-Class State Agency • Connect Texas Communities

An Equal Opportunity Employer

www.go10elpaso.com | facebook.com/go10elpaso | twitter.com/go10ep

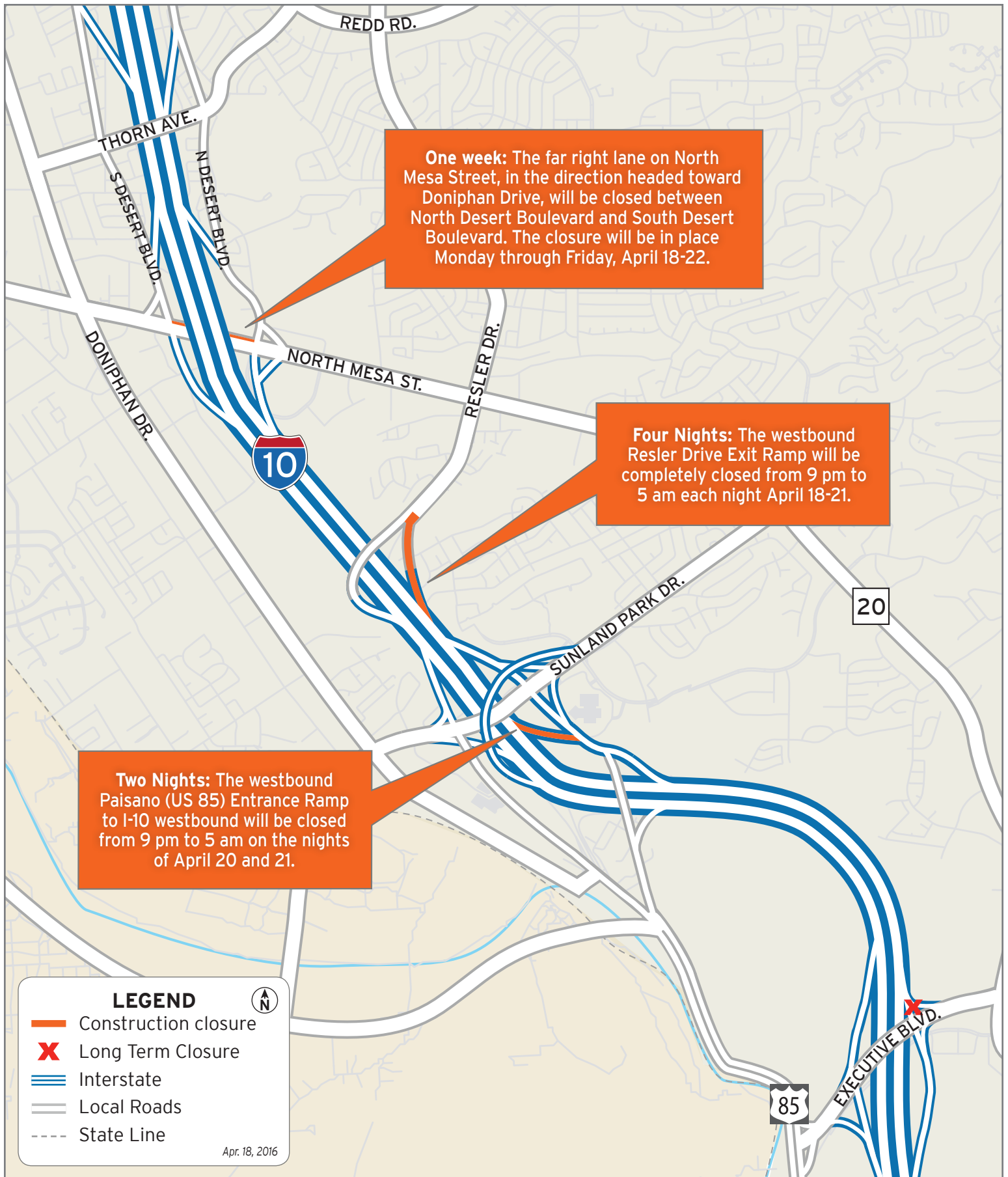

Closures at North Mesa, Resler and Paisano

