

TRAFFIC ALERT

TRAFFIC PATTERN SWITCH COMING TO SUNLAND PARK

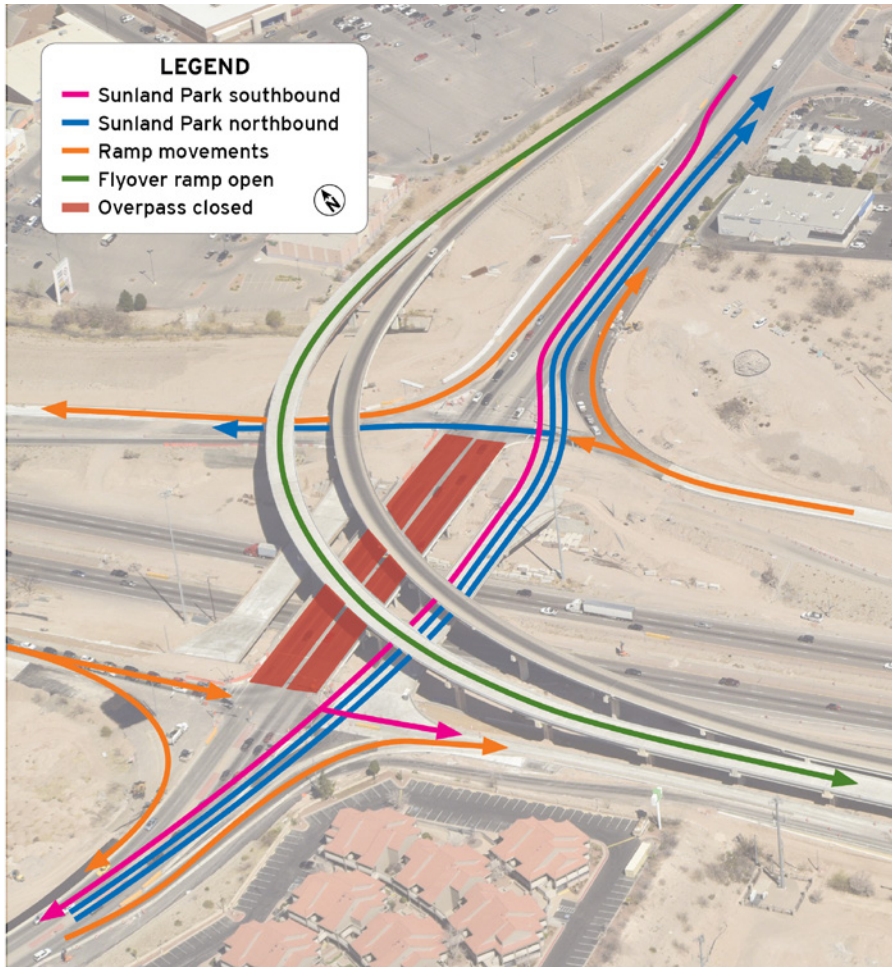

GO 10 crews will close the Sunland Park Drive overpass for *at least* five months starting on April 30. During this closure, traffic will be detoured onto the newly constructed turnaround bridge located parallel to the closed overpass (as illustrated).

This bridge closure is necessary so crews may demolish and replace the Sunland Park Drive overpass (shaded in red). The replaced overpass will have an increased clearance height and additional lanes. Its new support columns will be located to make way for the collector-distributor (CD) lanes, which run alongside I-10's main lanes.

The detour onto the turnaround bridge will mean fewer through lanes for motorists to get across I-10 (as shown by the pink and blue lines). This condition will be in place for *at least* five months.

Remember, the Sunland Park flyover ramp will be open before this detour is implemented. Also keep in mind, **GO 10** is aiming to be substantially complete with structures at the I-10/Sunland Park interchange by December 2018.

To learn more about this closure and detour, contact **GO 10** at info@go10elpaso.com or 1-844-373-Go10 (4610).

All closures are subject to change. Updates are posted to the **GO 10** website at go10elpaso.com.



LEGEND



- Sunland Park southbound
- Sunland Park northbound
- Ramp movements
- Flyover ramp open
- Overpass closed

Map not to scale

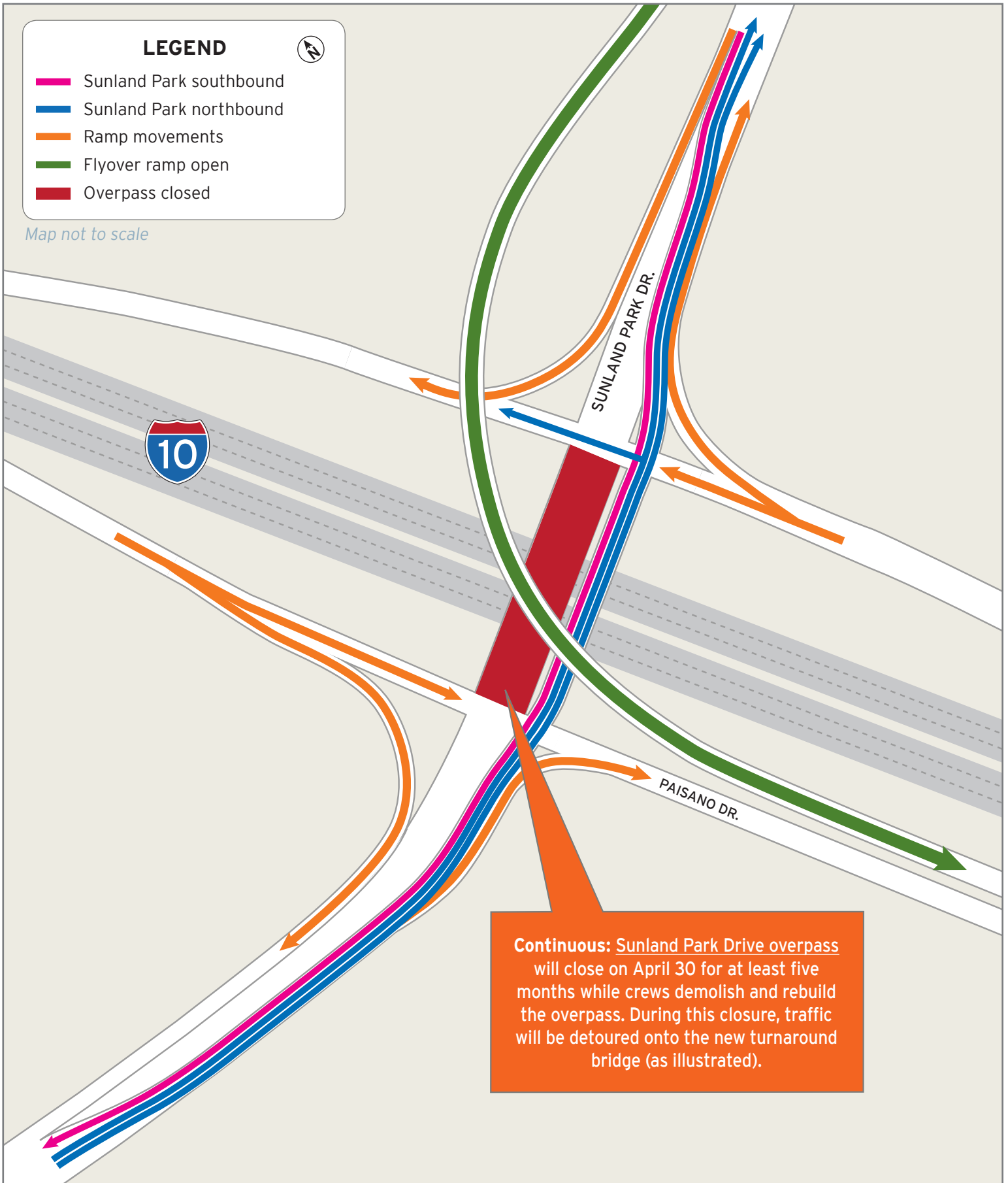

Continuous: Sunland Park Drive overpass will close on April 30 for at least five months while crews demolish and rebuild the overpass. During this closure, traffic will be detoured onto the new turnaround bridge (as illustrated).



Traffic Switch on Sunland Park Drive

